



HOME REFLECTIONS DESIGN

20 GRAYSON GR



These are preliminary renderings ONLY and are subject to change



2 Living Rooms

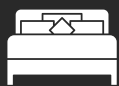

3 Bedrooms



2.5 Bathrooms



Attached
Double Garage



2-Story
Half-Duplex



1572 Square Feet

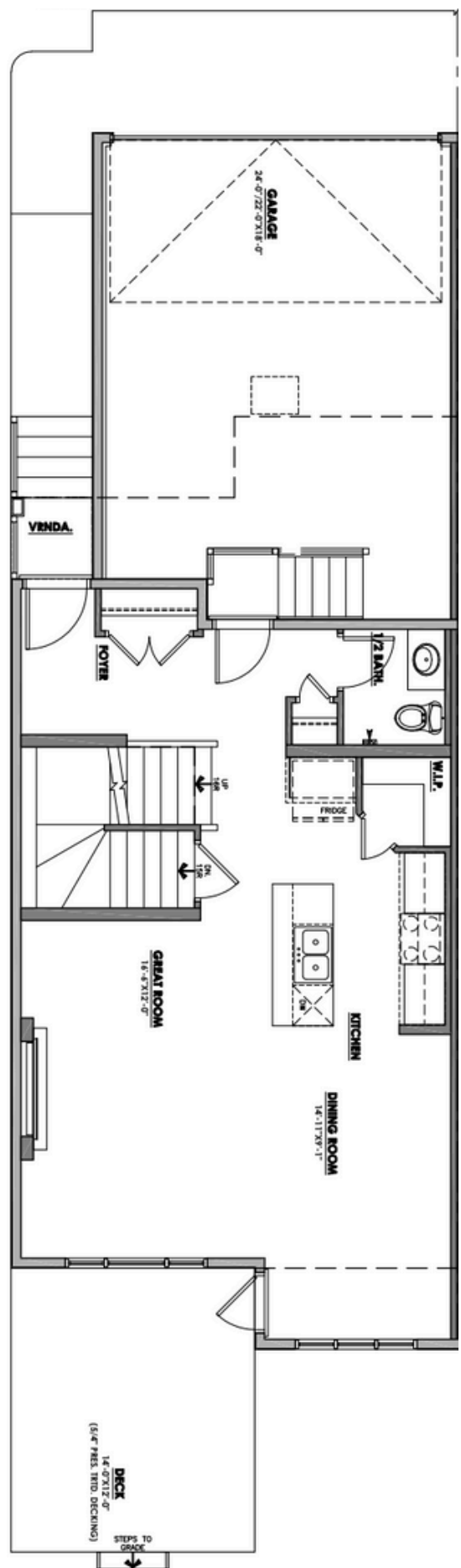

20 GRAYSON GREEN

Main Floor



2 Living Rooms

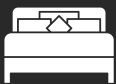

3 Bedrooms



2.5 Bathrooms



Double Garage



2-Story



2473 Square Feet

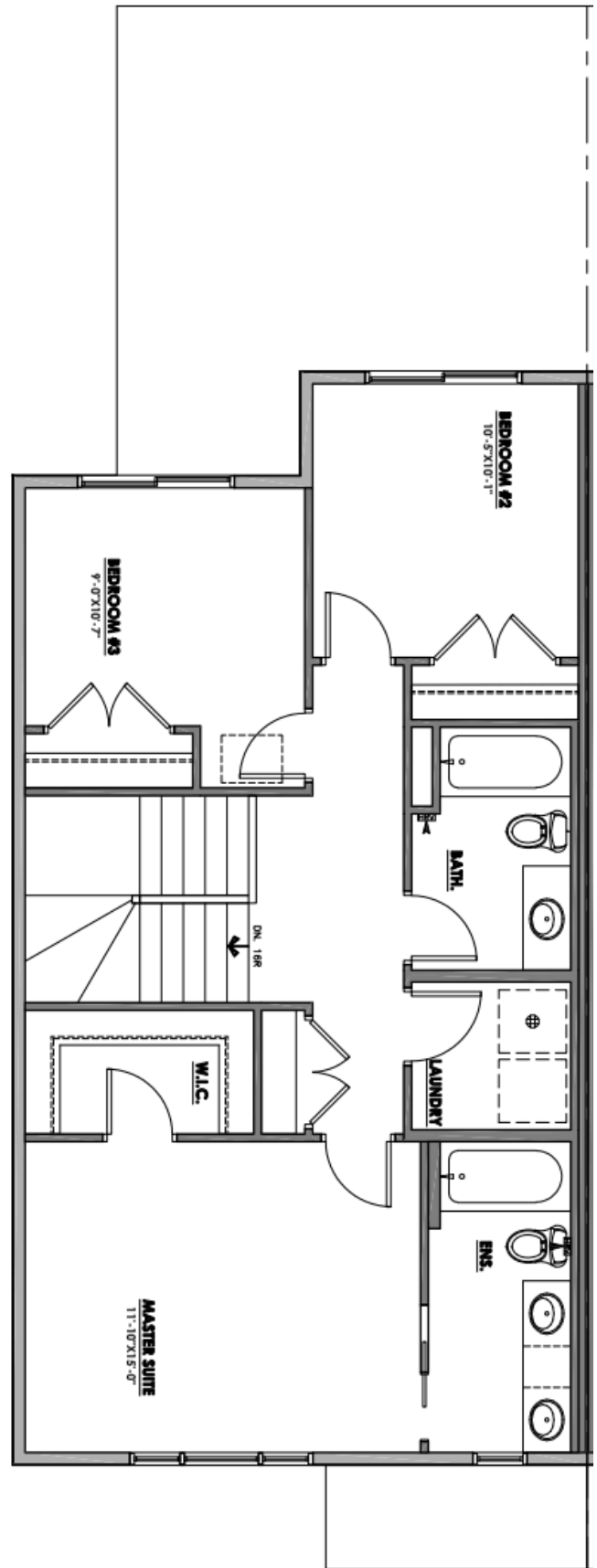

20 GRAYSON GREEN

Upper Floor



2 Living Rooms

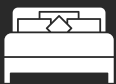

3 Bedrooms



2.5 Bathrooms



Double Garage



2-Story



2473 Square Feet



CONTACT US AT

HRD HOMES

WWW.BUILDHRD.COM

[@HRDHOMES_](https://www.instagram.com/HRDHOMES_)

5015 51 Ave

Stony Plain, AB

sales@buildhrd.com

587-991-9405



HOME FEATURES

- CUSTOM VENETIAN PLASTER HOOD FAN & FIREPLACE DESIGN
- OAK WOOD ACCENTS
- CUSTOM DESIGNED FEATURE WALLS IN THE DINING ROOM & PRIMARY BEDROOM
- DOUBLE GARAGE & RV BAY
- AIR CONDITIONING
- GARAGE WITH HEATER, FLOOR DRAIN AND HOT & COLD HOSE BIBS



20 GRAYSON GREEN
STONY PLAIN, AB

UPGRADED FEATURES & ENHANCEMENTS

THIS HOME INCLUDES PREMIUM UPGRADES BEYOND THE STANDARD SPECIFICATIONS, OFFERING ADDED VALUE, STYLE, AND FUNCTIONALITY!

- **CABINETRY:** TWO-TONE KITCHEN WITH WOOD GRAIN ISLAND & SAME WOOD GRAIN CABINETS IN ALL BATHROOMS, UPGRADED FROM STANDARD SOLID COLOUR THROUGHOUT
DECORATIVE CABINET WITH TOUCH-LATCH HARDWARE OVER OTR MICROWAVE
UPGRADED FROM STANDARD CABINET
- **CABINET HARDWARE:** MATTE BLACK KNOBS AND PULLS UPGRADED FROM STANDARD CHROME PULLS
- **PLUMBING:** WHITE SILGRANIT KITCHEN SINK UPGRADED FROM STANDARD STAINLESS STEEL SINK
MATTE BLACK KITCHEN FAUCET UPGRADED FROM STANDARD CHROME FAUCET
- **LIGHTING FIXTURES:** MATTE BLACK LIGHT FIXTURES UPGRADED FROM STANDARD CHROME
- **BATHWARE:** MATTE BLACK BATHWARE UPGRADED FROM STANDARD CHROME
- **FIREPLACE:** CUSTOM FIREPLACE WITH STAINED MAPLE ISLAND AND BUILT-IN NOOKS WITH STAINED MAPLE FLOATING SHELVES
- **RAILING:** STAINED MAPLE HANDRAIL UPGRADED FROM STANDARD PAINTED HANDRAIL

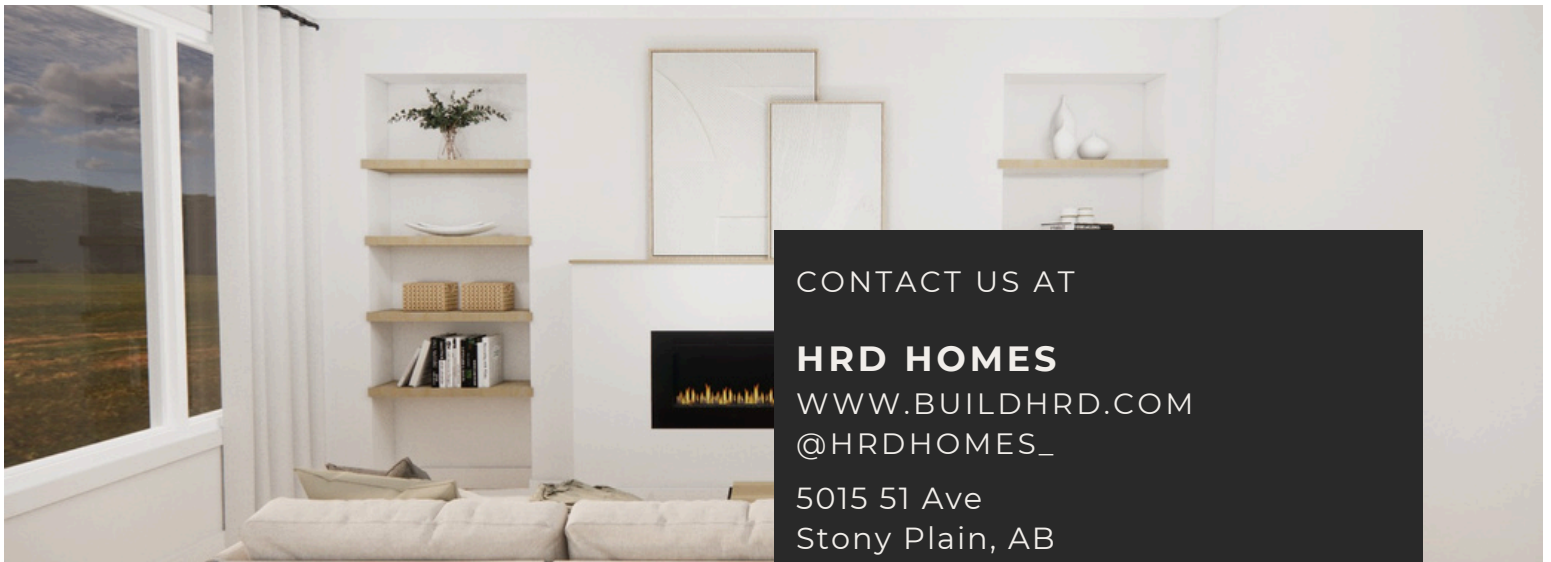

CONTACT US AT

HRD HOMES

WWW.BUILDHRD.COM

@HRDHOMES_

5015 51 Ave

Stony Plain, AB

sales@buildhrd.com

587-991-9405